



# VersiJet™ Series

## HIGH CAPACITY PUMPS

**The New VersiJet High Capacity Pumps are backed by Flojet's diaphragm pump technology, a brand enjoying over 35 years of operational excellence. The innovative new and improved five chamber design offers unequalled performance, capable of handling up to 6 GPM at open flow.**

With pressures up to 70 psi (4.8 bar), self-priming capabilities up to 10 feet (wetted), and heavier duty brushes extending the operating life up to 50% longer than existing Flojet Quad Series diaphragm pumps, the Flojet VersiJet pumps are designed to be the most reliable and versatile pumps on the market today. These pumps are the ideal solution for applications including spraying, fluid transfer, filtration, cooling, dispensing and pressure boosting.

The Flojet VersiJet Series High Capacity Pumps are made from Santoprene®/EPDM and Santoprene®/Viton®, resulting in true compatibility with most harsh and abrasive chemicals.

### Features and Benefits

- Multiple sizing options, providing flow up to 6 GPM (22.7 LPM) and pressure up to 70 psi (4.8 bar)
- Robust material selection, suitable for handling a broad range of chemicals
- Co-injected molded diaphragm technology, ensuring run dry capability, extending the life of the pump upwards of 50%
- IPX6 rated pump with a sealed motor and pressure switch, providing years of dependable reliability
- Self priming, accommodating up to 10ft (3m) (wetted)



**FLOJET**  
a xylem brand

# VersiJet Series HIGH CAPACITY PUMPS



## Applications



### • General Industrial

- Chemical Washdown
- Evaporative Cooling Systems
- Fluid Transfer



### • Agricultural

- Fogging / Misting
- Boom Sprayers (to reach tree tops)



### • Automotive

- DEF (Diesel Exhaust Fluid) Transfer
- Fluid Exchange Exhaust Cleaning

## Head-Flow Chart

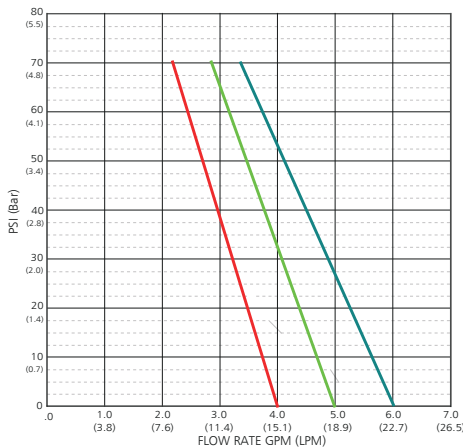

### 4.0 GPM

PSI	GPM	AMPS
0	4.0	3.6
10	3.8	5.0
20	3.5	6.4
30	3.3	7.8
40	3.0	9.0
50	2.7	10.1
60	2.5	11.1
70	2.2	12.0

### 5.0 GPM

PSI	GPM	AMPS
0	5.0	5.5
10	4.7	7.9
20	4.4	9.5
30	4.1	10.9
40	3.8	12.1
50	3.4	13.1
60	3.1	14.0
70	2.8	14.7

### 6.0 GPM

PSI	GPM	AMPS
0	6.0	7.4
10	5.7	8.3
20	5.3	10.1
30	4.9	11.6
40	4.5	13.0
50	4.1	14.4
60	3.7	15.2
70	3.3	15.6

### 15.1 LPM

PSI	GPM	AMPS
0	15.1	3.6
0.7	14.2	5.0
1.4	13.3	6.5
2.0	12.3	7.8
2.8	11.3	9.0
3.4	10.3	10.1
4.1	9.3	11.1
4.8	8.3	12.0

### 18.9 LPM

PSI	GPM	AMPS
0	18.9	5.5
0.7	18.1	7.9
1.4	16.8	9.5
2.0	15.5	10.9
2.8	14.2	12.1
3.4	13.0	13.1
4.1	11.9	14.0
4.8	10.6	14.7

### 22.7 LPM

PSI	GPM	AMPS
0	22.7	7.4
0.7	21.4	8.3
1.4	20.0	10.1
2.0	18.5	11.6
2.8	17.0	13.0
3.4	15.5	14.4
4.1	14.0	15.2
4.8	12.5	15.6

Note: Pressure, flow and Amp data is tested at 12.8 volts.  
See Flojet R7300 series for 7.0 GPM models.

## Specifications

Motor Design	Perm. Magnet TENV (non-ventilated)
Voltage Options	12 VDC, 24 VDC, 115 VAC, 230 VAC
Pump Head Material	Glass Filled Nylon
Diaphragm Elastomer	Santoprene®
Check Valve Materials	Glass Filled Nylon, EPDM or Viton®
Maximum Flow Rate	6.0 GPM (22.7 LPM)
Maximum Pressure	70 psi (4.8 bar)
Duty Cycle	Intermittent
Weight	7.6lbs (3.5kg)
Certifications	CE, RoHs, IPX6
Standard Port Size Inlet/Outlet	1/2" HB (4 GPM), 3/4" HB (5 and 6 GPM)

## Dimensional Drawing - 5 GPM / 6 GPM models

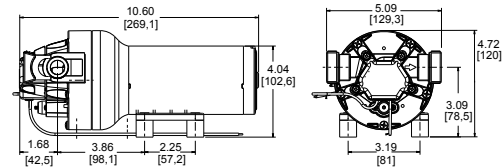

Note: 4 GPM model overall length 9.91in (251.7mm). All other dimensions are the same as the 5 GPM / 6 GPM models. Dimensions in inches [mm]

Part No.	Volts	GPM (LPM)	Switch PSI (Bar)	Diaphragm	Check Valve
R8400144	12	4 (15.1)	70 (4.8)	Santo	EPDM
R8400344	24	4 (15.1)	70 (4.8)	Santo	EPDM
R8400044	115	4 (15.1)	70 (4.8)	Santo	EPDM
R8400244	230	4 (15.1)	70 (4.8)	Santo	EPDM
R8400134	12	4 (15.1)	70 (4.8)	Santo	Viton
R8400334	24	4 (15.1)	70 (4.8)	Santo	Viton
R8400034	115	4 (15.1)	70 (4.8)	Santo	Viton
R8400234	230	4 (15.1)	70 (4.8)	Santo	Viton

Part No.	Volts	GPM (LPM)	Switch PSI (Bar)	Diaphragm	Check Valve
R8500144	12	5 (18.9)	70 (4.8)	Santo	EPDM
R8500344	24	5 (18.9)	70 (4.8)	Santo	EPDM
R8500044	115	5 (18.9)	70 (4.8)	Santo	EPDM
R8500244	230	5 (18.9)	70 (4.8)	Santo	EPDM
R8500134	12	5 (18.9)	70 (4.8)	Santo	Viton
R8500334	24	5 (18.9)	70 (4.8)	Santo	Viton
R8500034	115	5 (18.9)	70 (4.8)	Santo	Viton
R8500234	230	5 (18.9)	70 (4.8)	Santo	Viton

Part No.	Volts	GPM (LPM)	Switch PSI (Bar)	Diaphragm	Check Valve
R8600144	12	6 (22.7)	70 (4.8)	Santo	EPDM
R8600344	24	6 (22.7)	70 (4.8)	Santo	EPDM
R8600044	115	6 (22.7)	70 (4.8)	Santo	EPDM
R8600244	230	6 (22.7)	70 (4.8)	Santo	EPDM
R8600134	12	6 (22.7)	70 (4.8)	Santo	Viton
R8600334	24	6 (22.7)	70 (4.8)	Santo	Viton
R8600034	115	6 (22.7)	70 (4.8)	Santo	Viton
R8600234	230	6 (22.7)	70 (4.8)	Santo	Viton

Santoprene® is a registered trademark of Monsanto.

Viton® is registered trademark of DuPont Performance Elastomers.



Warranty: All products of the company are sold and all services of the company are offered subject to the company's warranty and terms and conditions of sale, copies of which will be furnished upon request. The information provided herein is for guidance only, it does not constitute a guarantee of the performance or specification of any individual product or component.

[www.xyleminc.com](http://www.xyleminc.com)

USA  
Xylem Inc.  
100 Cummings Center Drive  
Suite 535-N, Beverly, MA 01915  
Tel: +1 978 281-0440  
Fax: +1 978 283-2619

UK  
Xylem Inc.  
Bingley Road, Hoddesdon  
Hertfordshire EN11 0BU  
Tel: +44 (0) 1992 450145  
Fax: +44 (0) 1992 467132

GERMANY  
Xylem Inc.  
Oststrasse 28  
22844 Norderstedt  
Tel: +49-40-53 53 73-0  
Fax: +49-40-53 53 73-11

CHINA  
Xylem Inc.  
30/F, Tower A Hongqiao City  
Center of Shanghai 100 Zunyi  
Road, Shanghai 200051, China  
Tel: +(86) 21 2208 2888  
Fax: +(86) 21 2208 2999

ITALY  
Xylem Inc.  
Via Tommaseo, 6  
20059 Vimercate, Milano  
Tel: +39 039 685 2323  
Fax: +39 039 666 307