

ENVALVE SERIE VK11-VK21 HORA 75 - 200 MM

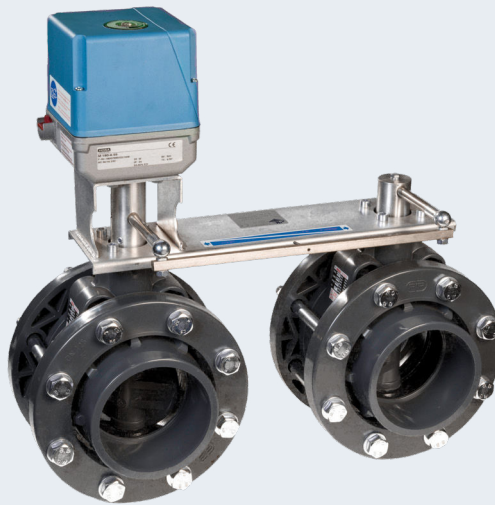

motor operated double butterfly valves



[Motorized / pneumatic control valves](#) [Fittings](#)

Description

Envalve butterfly valves are designed to isolate or regulate flow. As they are electrically powered, they can be controlled by remote. The butterfly valves are made from PVC and have been provided with an EPDM gasket to enable them to withstand contact with corrosive substances. The valves are also available with a Viton® FPM gasket.

Advantages

- o Ample through put capacity
- o Low loss in pressure
- o Bidirectional flow
- o Little installation space needed
- o Few parts
- o Emergency manual operation available

As they are electrically powered, the valves can be controlled by remote. The axle is connected to an electric motor for convenient operation of the valve. This motor has a supply voltage of 24VAC. Motors with a supply voltage of 230 V are available on request.

The motor can rotate bidirectionally and is controlled by the phase of the supply voltage. Alternating the phase causes the valve to open or close, respectively. The final position of the valve is limited by two built-in limit switches. The motors are bi-stable, which means that if the valve is rotating to a specific position and the power supply is cut off, the valve will remain in this position. An indicator in the motor shows the position of the valve (large or small flow-through). The motor is equipped with an unlock button that can disconnect the motor and move the valve manually into whatever position. The butterfly valves are provided with flanges and collars. The gasket also serves as a seal. Option: extra limit switches and/or a heating element.

Model specifications

- o VK11: 1 valve - 1 motor
- o VK21: 2 valves - 1 motor

Valves with a Hora motor have a run time of 130 seconds at a rotation angle of 90°.

ENVALVE VK11-VK21 HORA

75 - 200 MM



Dimensions VK11 and VK21 75 - 200 FH

VK11

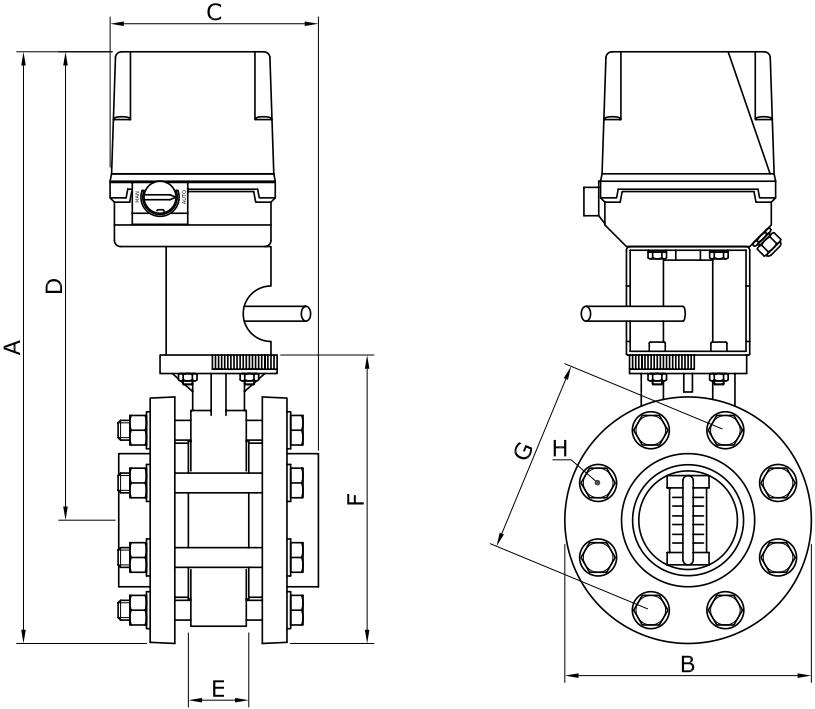

VK21

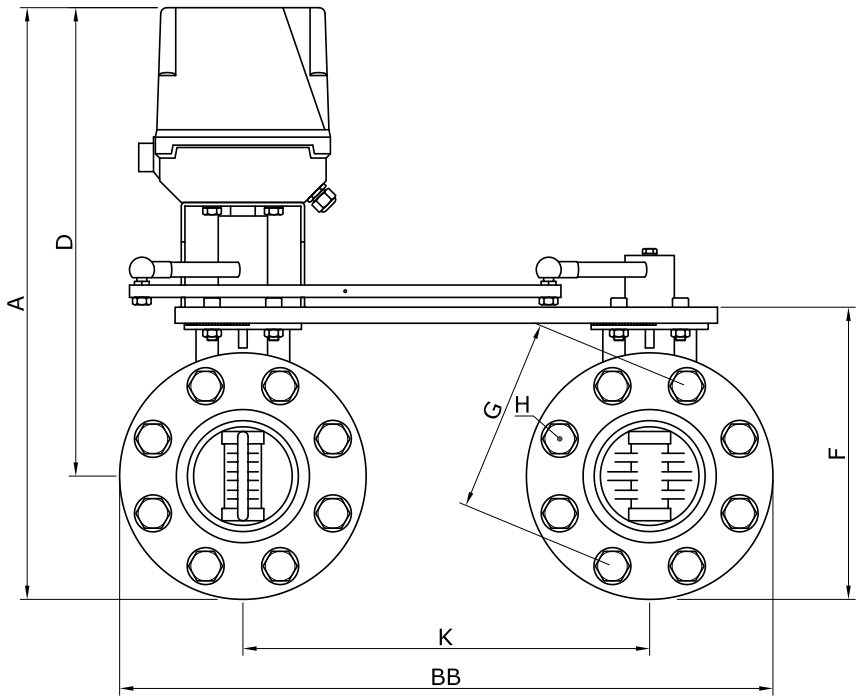

ENVALVE VK11-VK21 HORA

75 - 200 MM



Dimensions VK11 and VK21 75 - 200 FH

VK11 AND VK21 75 - 315 FH											
VALVE TYPE	DN	A	B	BB	C	D	E	F	G	H	K
75	65	460	185	515	155	368	46	213	145	16×130	330
90	80	483	200	530	165	380	49	236	160	16×140	330
110	100	507	220	550	177	395	56	260	180	16×160	330
125	110	540	235	565	195	410	64	290	190	16×180	330
160	150	573	285	615/745	210	430	70	326	240	20×200	330/460
200	200	630	322	782	250	460	71	389	270	20×250	460

Technical specifications adjustment motors

MOTOR TYPE	M180
VOLTAGE	24VAC ±10% or 230VAC +6% -10%
FREQUENCY	50/60 Hz ± 5%
POWER	26W
TORQUE	80 Nm
RUN TIME	130 sec
PROTECTION CLASS	IP54
AMBIENT TEMPERATURE	0. + 50 °C
OPERATING CONDITION	100% ED
ASSEMBLY POSITION	SEE USER MANUAL

Hydraulic and dimensional data

TYPE	GLUE (mm)	DN	Kv VALUE (l/min)	WEIGHT (in kg)
VK 11-75FH	75	65	1700	8
VK11-90FH	90	80	3550	9
VK11-110FH	110	100	5900	10
VK11-125FH	125	110	9850	12
VK11-160FH	160	150	18700	17
VK11-200FH	200	200	30500	25
VK 21-75FH	75	65	2 × 1700	12
VK21-90FH	90	80	2 × 3550	16
VK21-110FH	110	100	2 × 5900	18
VK21-125FH	125	110	2 × 9850	23
VK21-160FH	160	150	2 × 18700	31
VK21-200FH	200	200	2 × 30500	47

Technical specifications valve

VALVE 75-200	
PLASTIC 2/2 WAY; FLANGES WITH BOLTS AND NUTS	
HOUSING	PVC
GASKET	EPDM
MAX. PRESSURE	10 BAR AT 20 °C
MAX. AMBIENT TEMP.	60 °C